

Vertical Section.
Scale 1:2

TIMBER:

Use hardwoods from Forest Stewardship Council (FSC) sources with an average density of 660Kg/m³ or higher and with 15% moisture content, such as 'Iroko' (Latin name: *Milicia excelsa*), 'Utile' (Latin name: *Entandrophragma utile*), or 'Sapele' (Latin name: *Entandrophragma cylindricum*) or a treated fast-growing softwood, modified by acetylation.

CONSTRUCTION:

All frames with mortice and tenon joints, timber generally free from unsound knots, loose knots or knot holes.

GLAZING:

Single glazed 6mm annealed glass, OR as pictured, slimline double glazed units, 11mm overall thickness comprising 4mm Low E⁺ outer pane, 4mm air cavity, 3mm glass inner pane, OR Vacuum Insulated glass, maximum thickness 11mm, although can be achieved with 8.3mm consisting of two 4mm panes with a 0.3mm vacuum space. A typical centre-pane U-value for vacuum glass is 0.4W/m²K. Units installed with lised oil putty and pinned.

GLAZING IN CRITICAL LOCATIONS:

Glazing in critical locations must be safety glass and comply with the requirements of Approved Document K of the Building Regulations. <https://www.gov.uk/government/publications/protection-from-falling-collision-and-impact-approved-document-k>

IRONMONGERY:

Where salvageable existing original ironmongery should be re-used. Surface mounted traditional latches in self coloured brass or black finish. If using softwood modified by acetylation, stainless steel ironmongery must be used.

DRAUGHT PROOFING:

Concealed compression or wiper seals around the perimeter of the frame may be fitted.

PAINT:

All areas to be pre-treated with linseed oil and knot sealed prior to application of one coat of alkyl primer. Two undercoats applied prior to applying one top coat of either oil based or water based paint in either egg shell or satin finish (not gloss). Finish can be either brush or spray applied and must be consistent throughout.

COLOUR:

The exterior surfaces of all rear windows to be painted white (BS 00 E 55).

SECONDARY GLAZING:

To be designated so far as practicable to minimize its visibility from the exterior of the building. No parts of the existing window construction is to be altered or removed, unless agreed otherwise in written by the local authority. Glass is not to be tinted. UPVC is not to be used.

Wirral Council is not liable for inaccuracies, poor workmanship or inadequate installation of features installed or replaced under the Order. Verify all dimensions and existing conditions on site, including profiles, height and width of all aspects of the window to be installed or replaced.

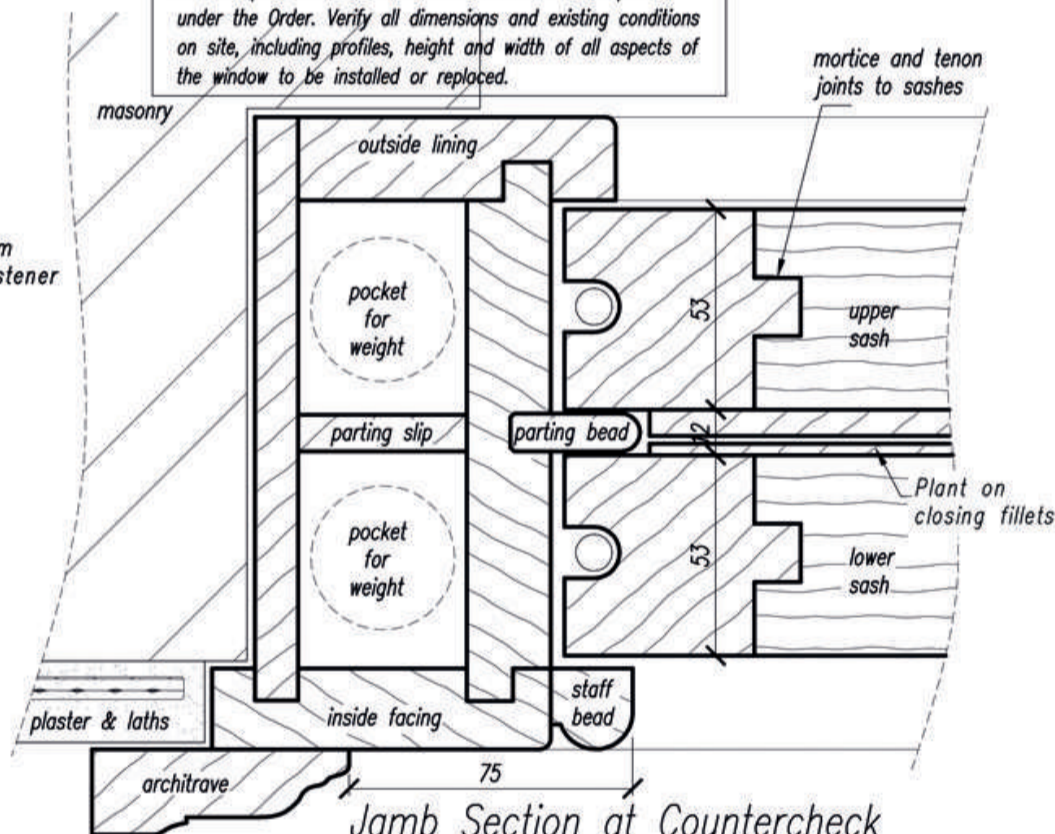

Jamb Section at Countercheck
Scale 1:2

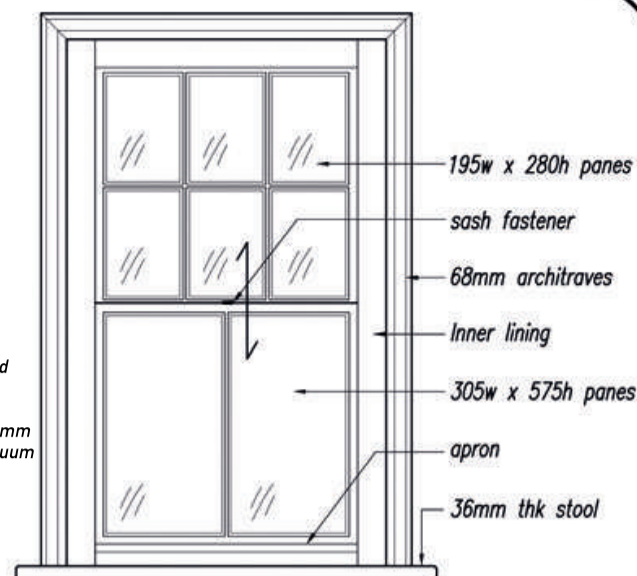

Internal Elevation. Scale 1:20

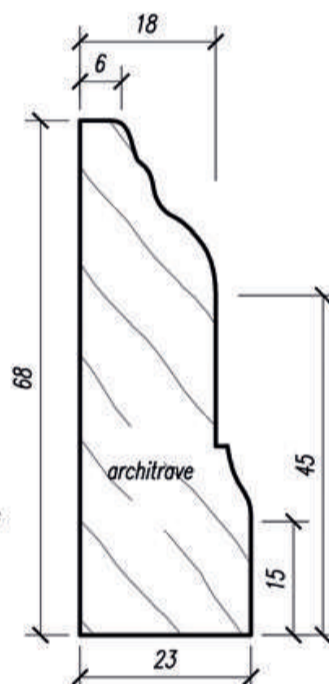
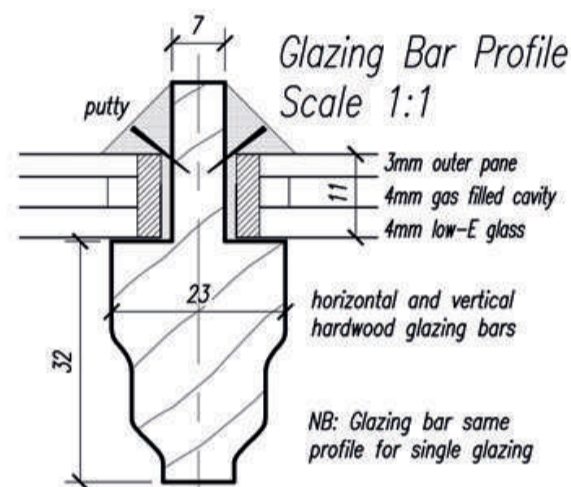

Architrave Profile
Scale 1:1

Double Glazing Detail

- 1 - 4mm low-E glass (laminated if required)
- 2 - 4mm gas filled cavity
- 3 - 3mm outer pane
- 4 - Aluminium spacer bar
- 5 - Sealant
- 6 - Perimeter Seal
- 7 - Hardwood spacers
- 8 - Sprig
- 9 - Putty line
- 10 - 1-2mm paint overlap onto glass

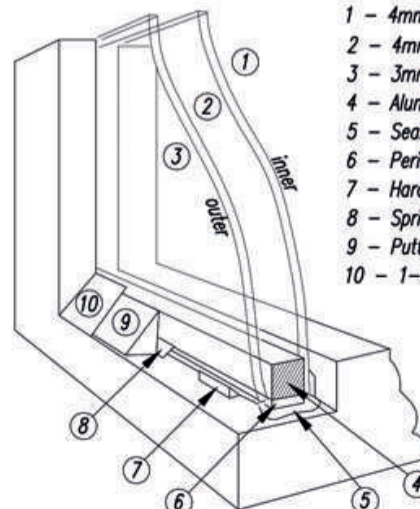

Port Sunlight LLBCO
Appendix 4

WIRRAL



Port Sunlight
VILLAGE TRUST

Date: 1/07/2025

Title: Vertical Double Hung Sash

A3 sheet. RevA.